

Designation Standard (Abstract)

1. The facility shall have a pre-heating area and a post-heating area.
(Designation Standard 1)
2. The pre-heating area shall have facilities for storage, treatment and inspection.
(Designation Standard 3)
3. The post-heating area shall be walled off from outside and have equipment or instruments for inspection, cooling, storage and packing after heat-processing .
(Designation Standard 5)
4. The pre-heating area and the post-heating area shall have individual facilities, such as entrance and exit, locker room, toilet, etc. (Designation Standard 6)
5. The post-heating area shall be completely isolated from the pre-heating area except for windows of heat-processing equipment. (Designation Standard 2)

1. Pre-heating area and Post-heating area

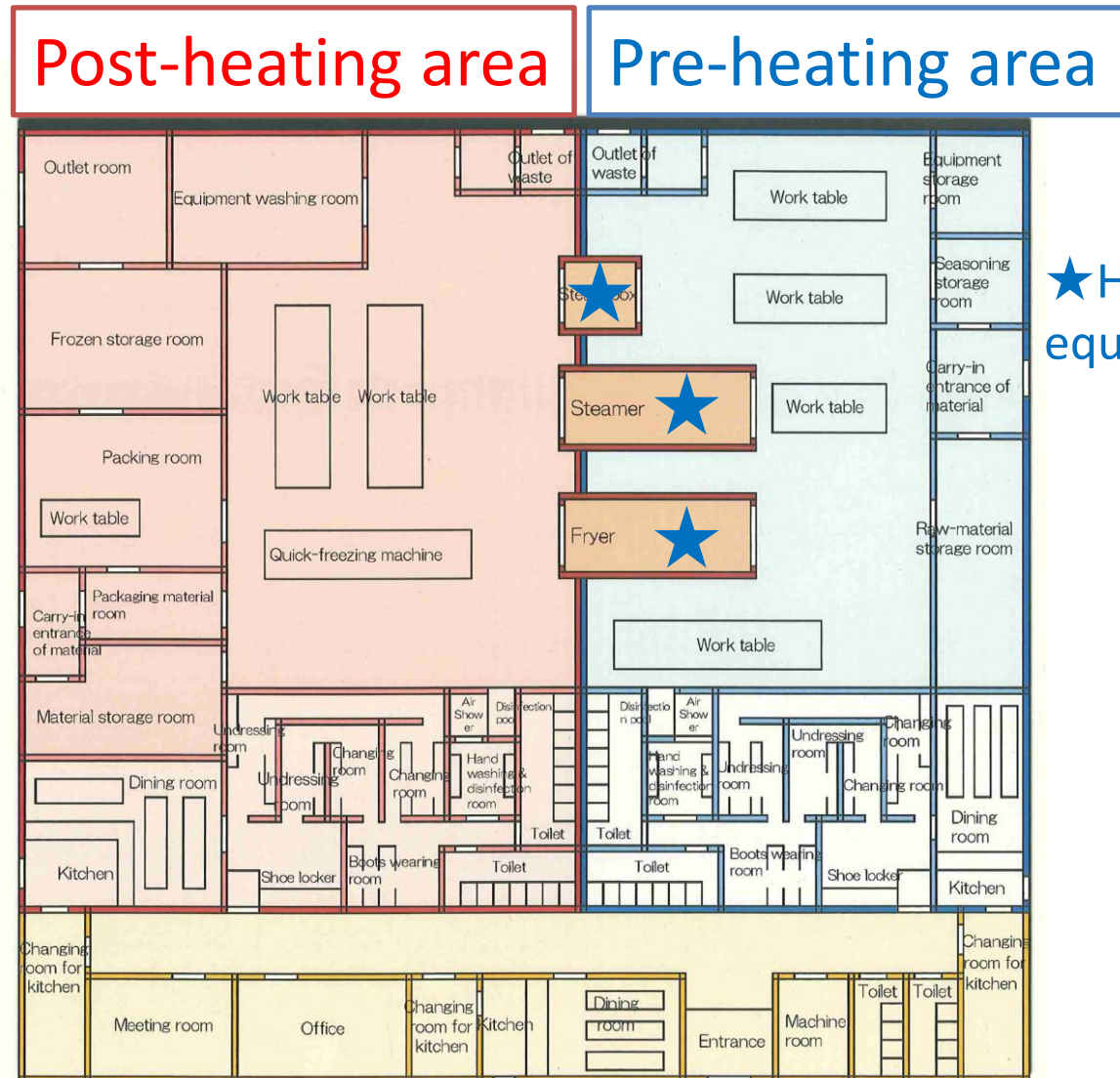

2. Pre-heating area

Heat-processing equipment

- Steamer
- Oven
- Fryer
- Boiler

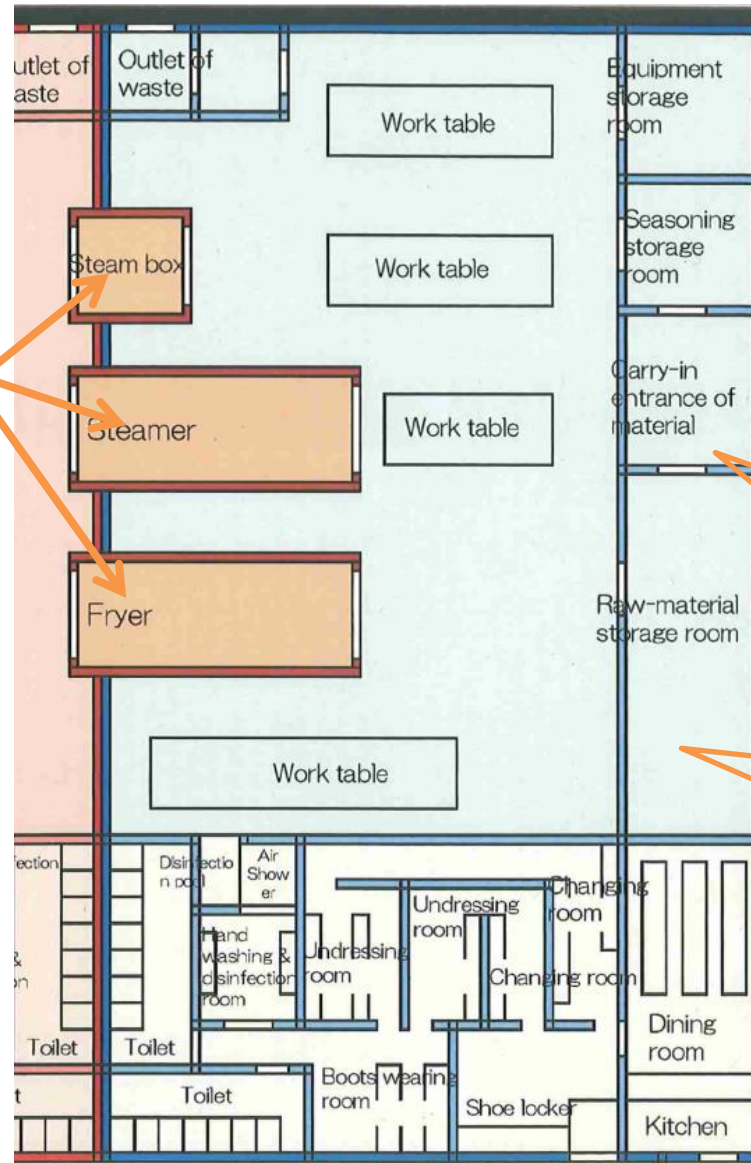

Receiving dock
for raw materials

Inspection facility
for raw materials

Storage for
raw materials

3. Post-heating area

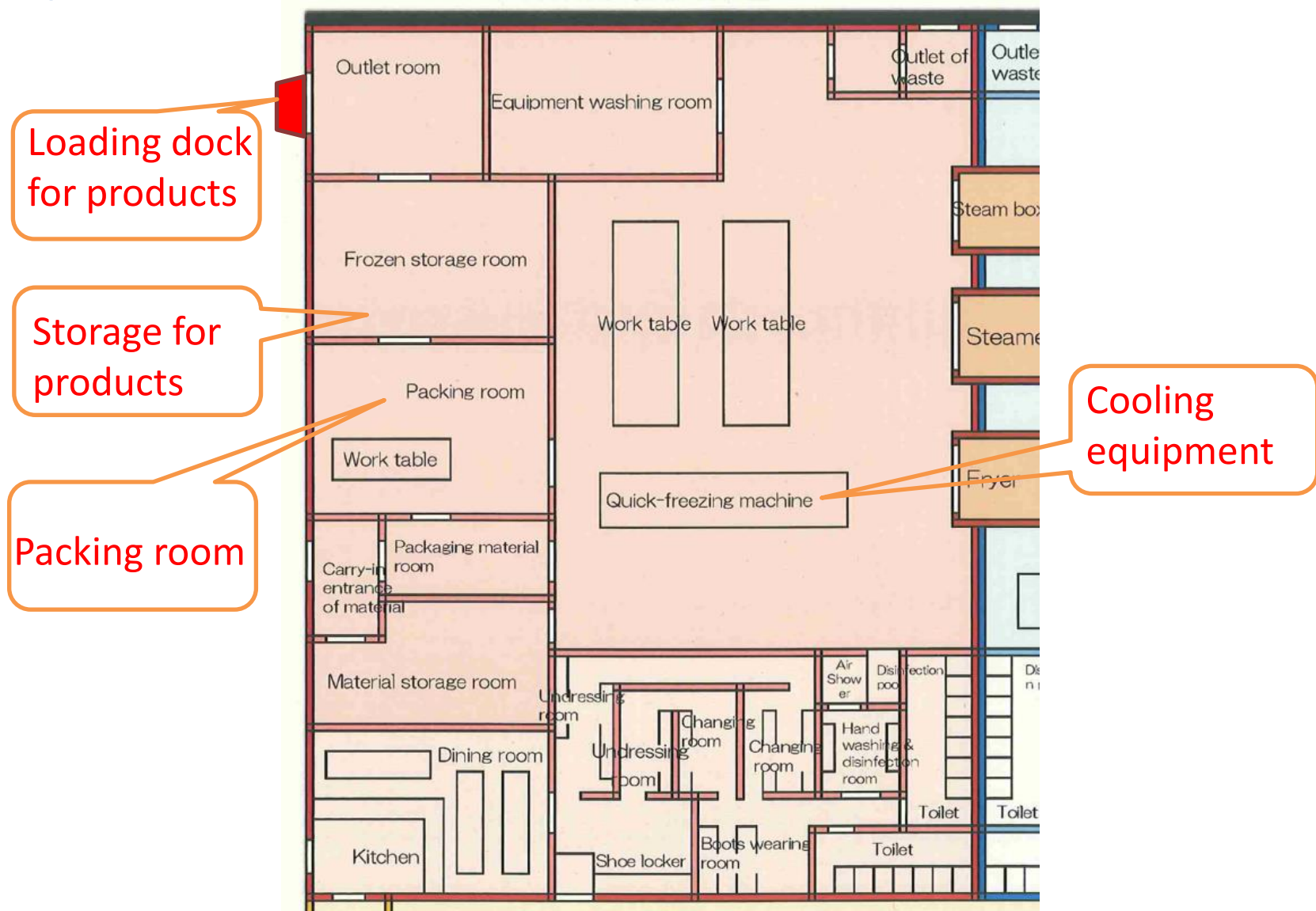

4. The pre-heating area and the post-heating area shall have individual facilities

Post-heating area

Pre-heating area

Entrance and exit, locker room, toilet, etc. for workers

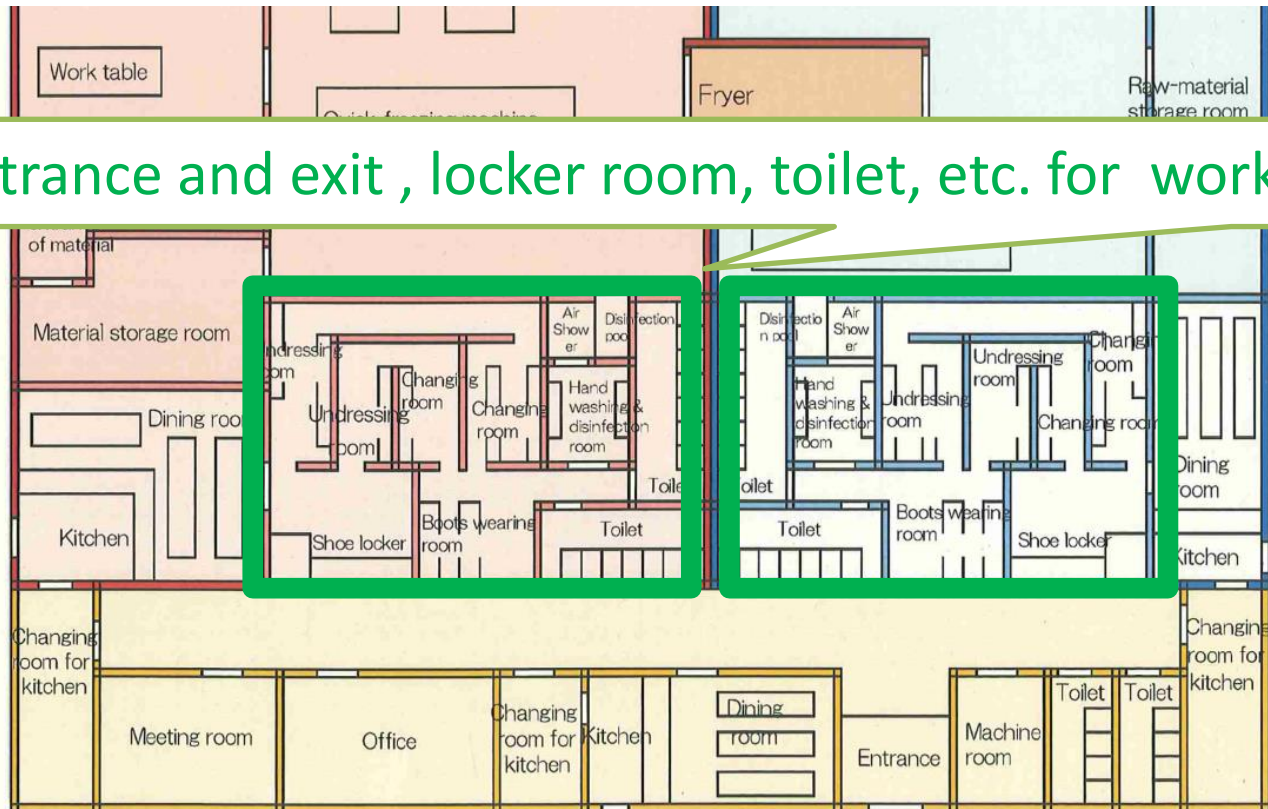

5. Isolation of post-heating area from pre-heating area

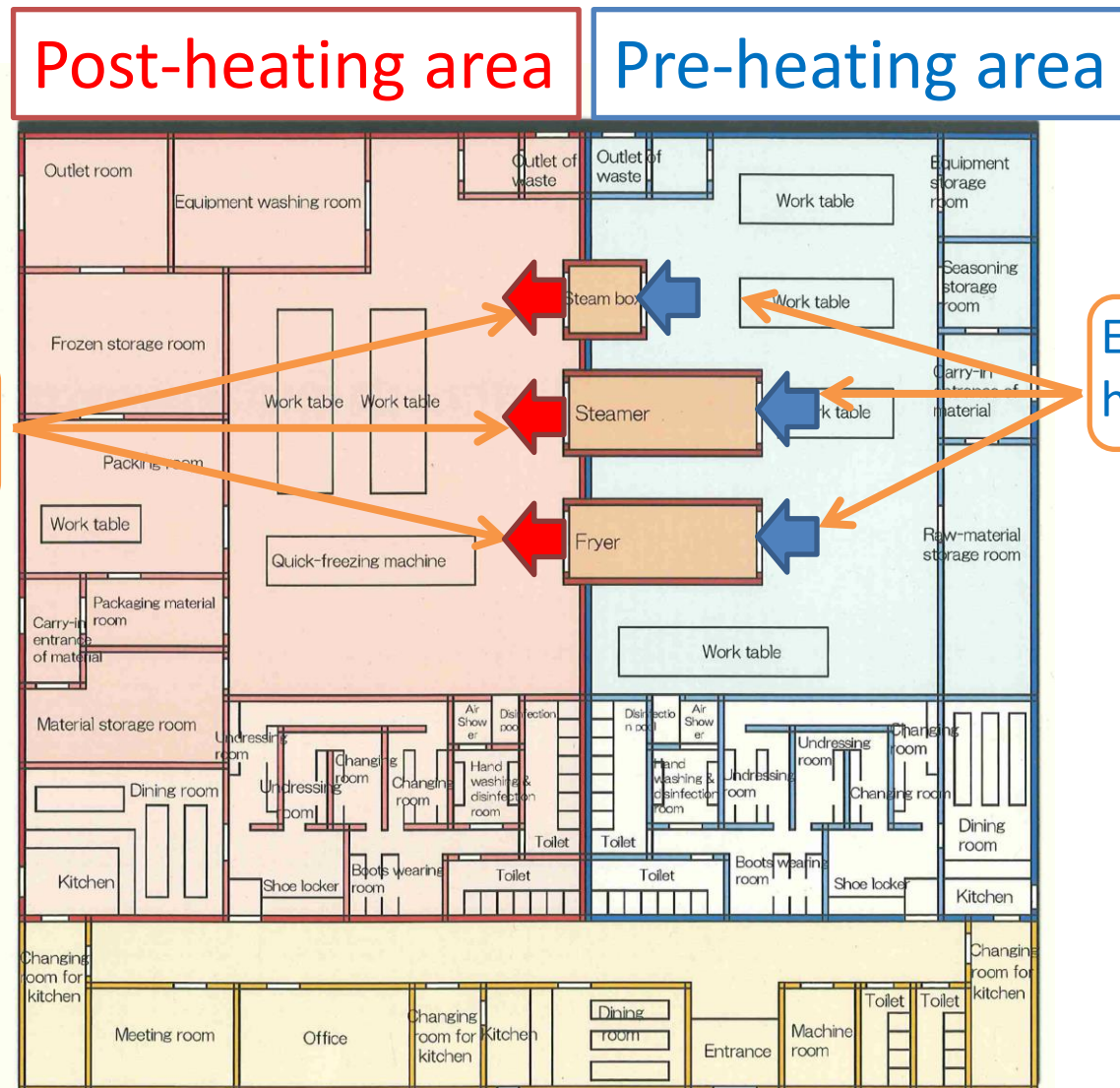

Structure of heating equipment (Batch-style)



Steamer

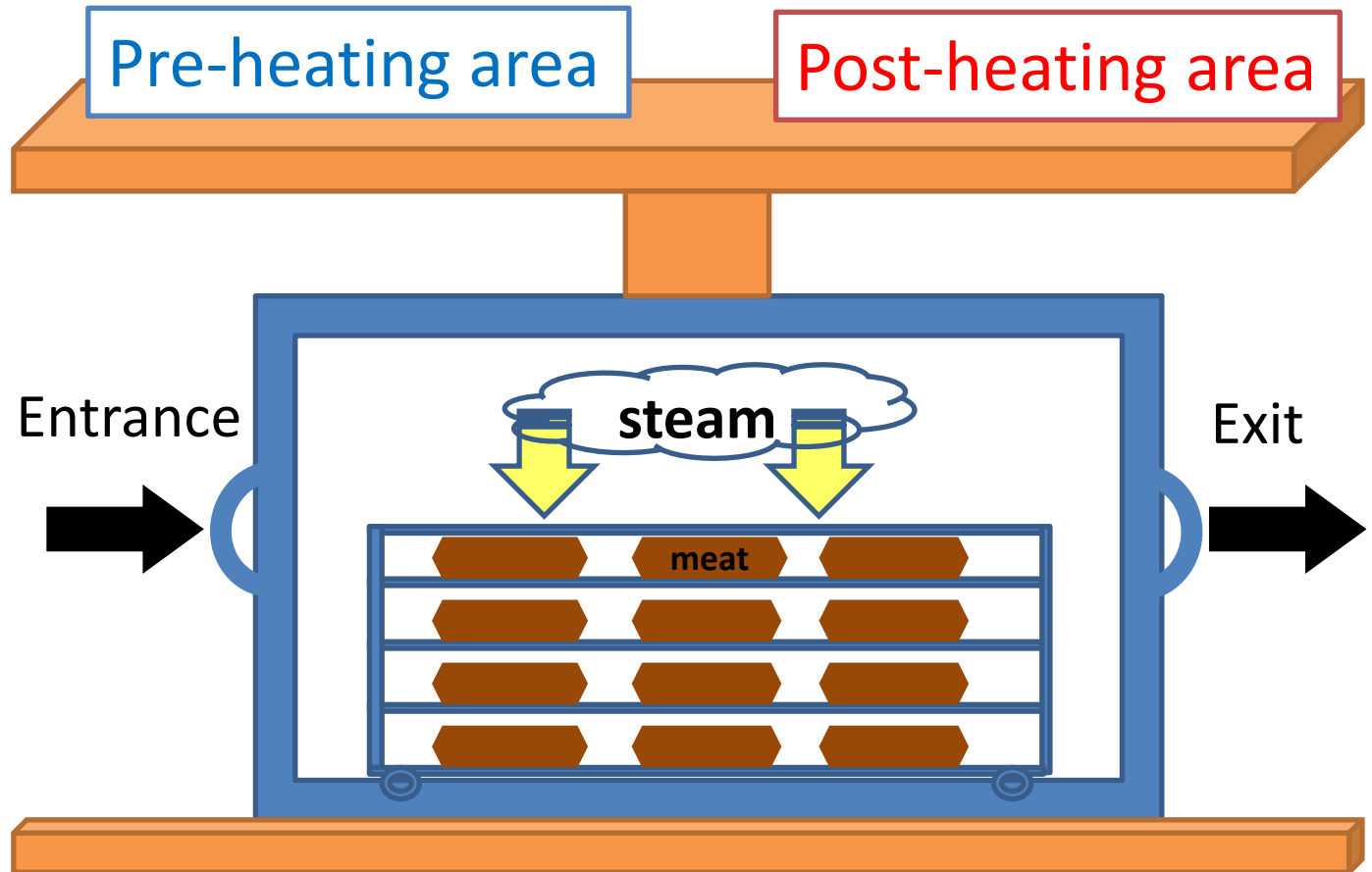

Entrance of heating equipment (Batch-style)

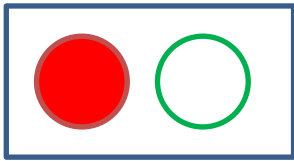

- This door is locked and can't be opened
- The door of the opposite side is open.

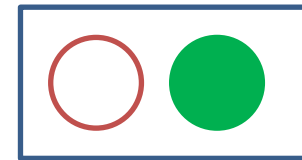

- This door can be opened.
- The door of the opposite side is locked.

6. Preventing measure against flow of air from pre-heating area into post-heating area(Continuou-style)

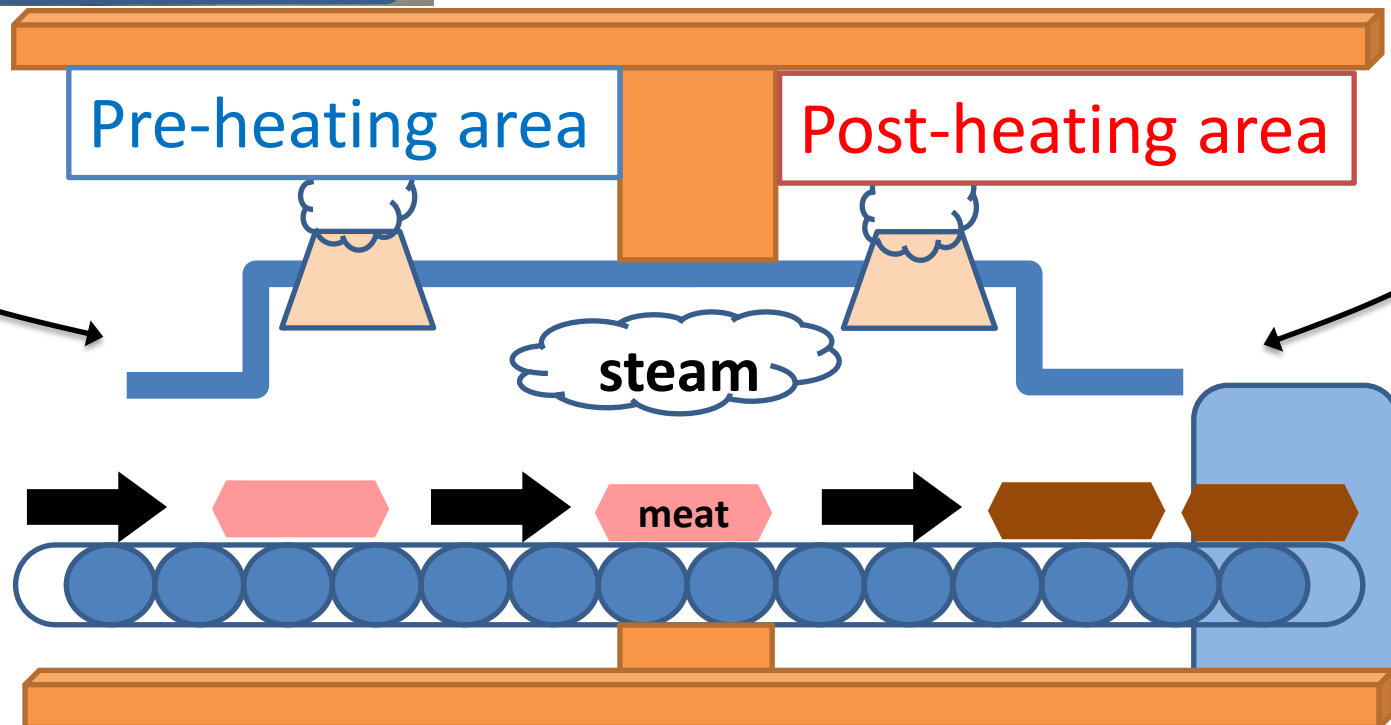

6. Preventing measure against flow of air from pre-heating area into post-heating area(Continuou-style)

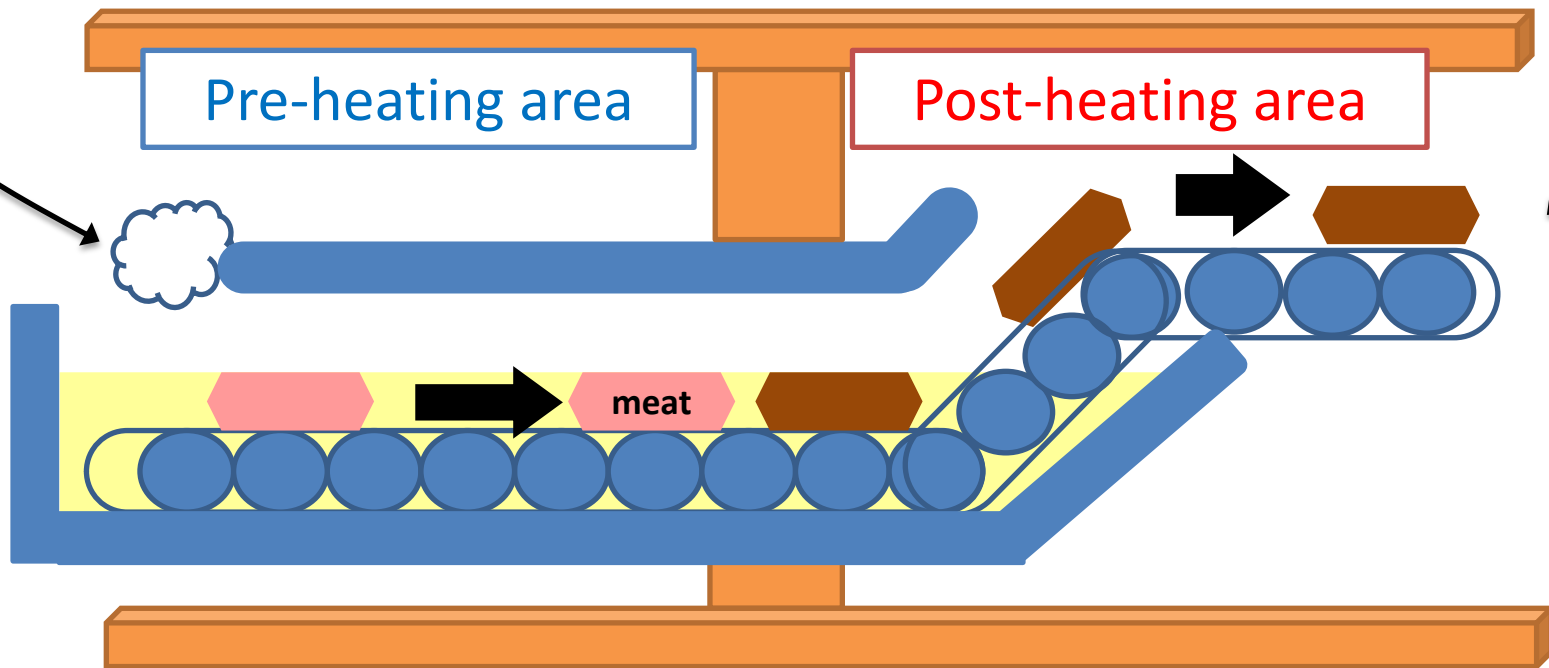
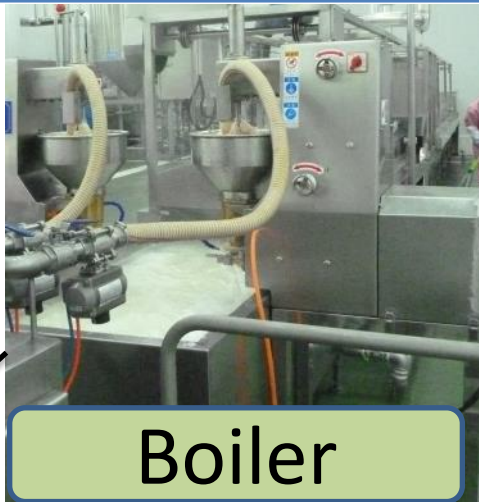

Measurement of core temperature (Batch-type)

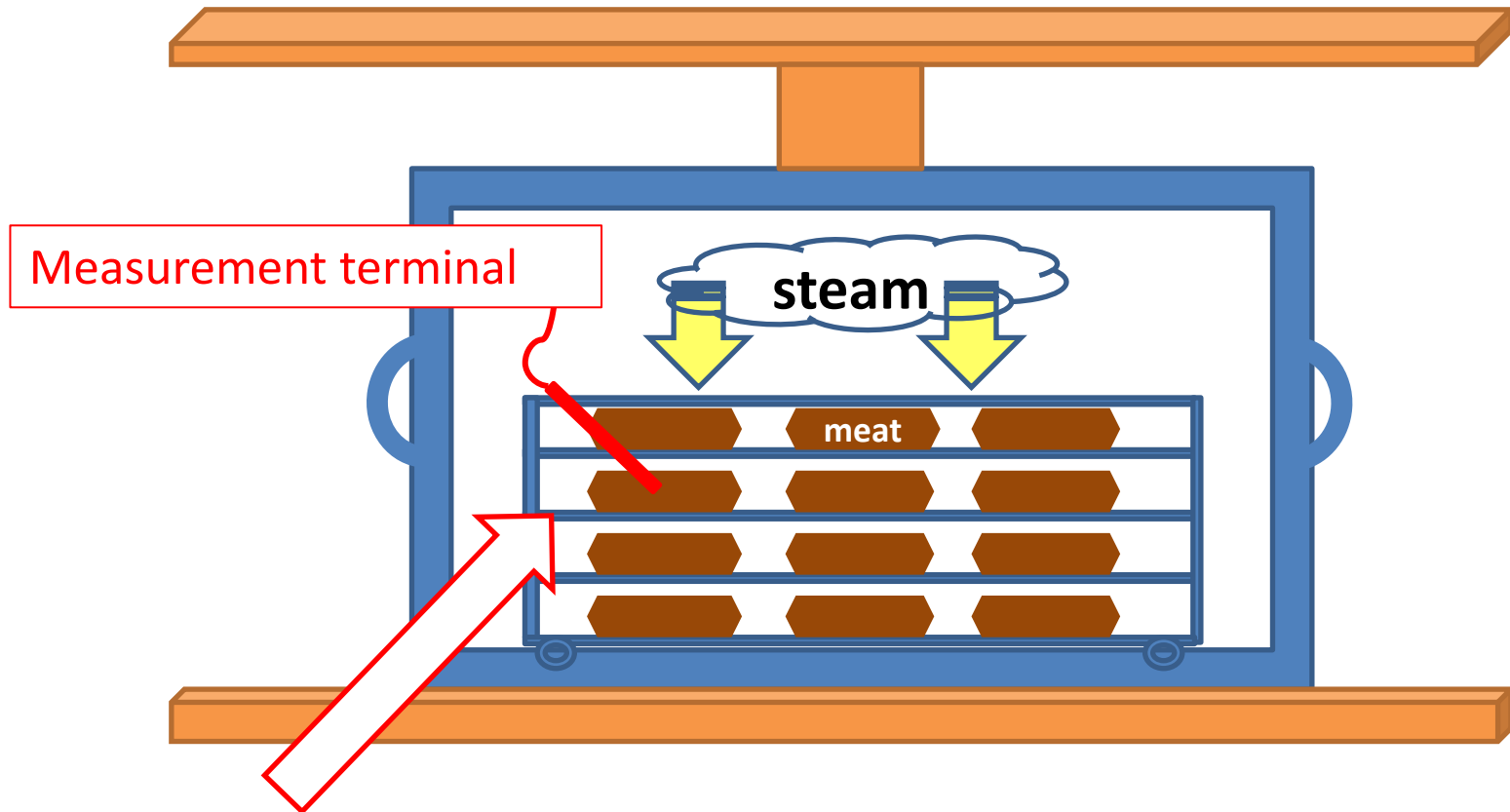

Insert the measurement terminal
into the center of the meat

*The measured temperature is
automatically recorded.

Measurement of core temperature (Continuous-style)

Post-heating area

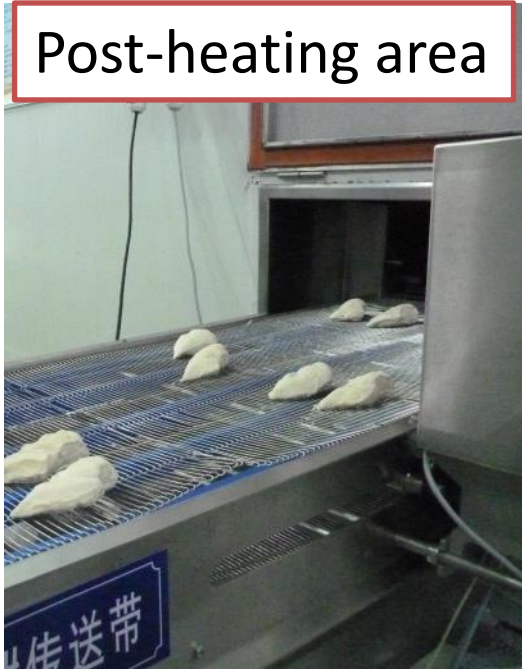

Meat

Thermometer

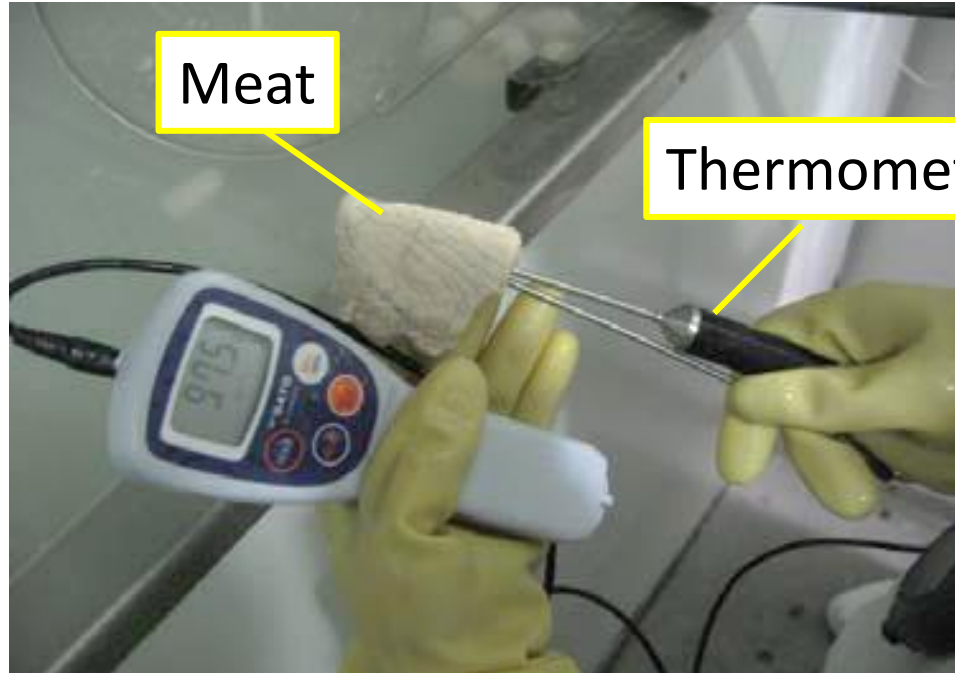

Traffic line of worker

Post-heating area

Pre-heating area

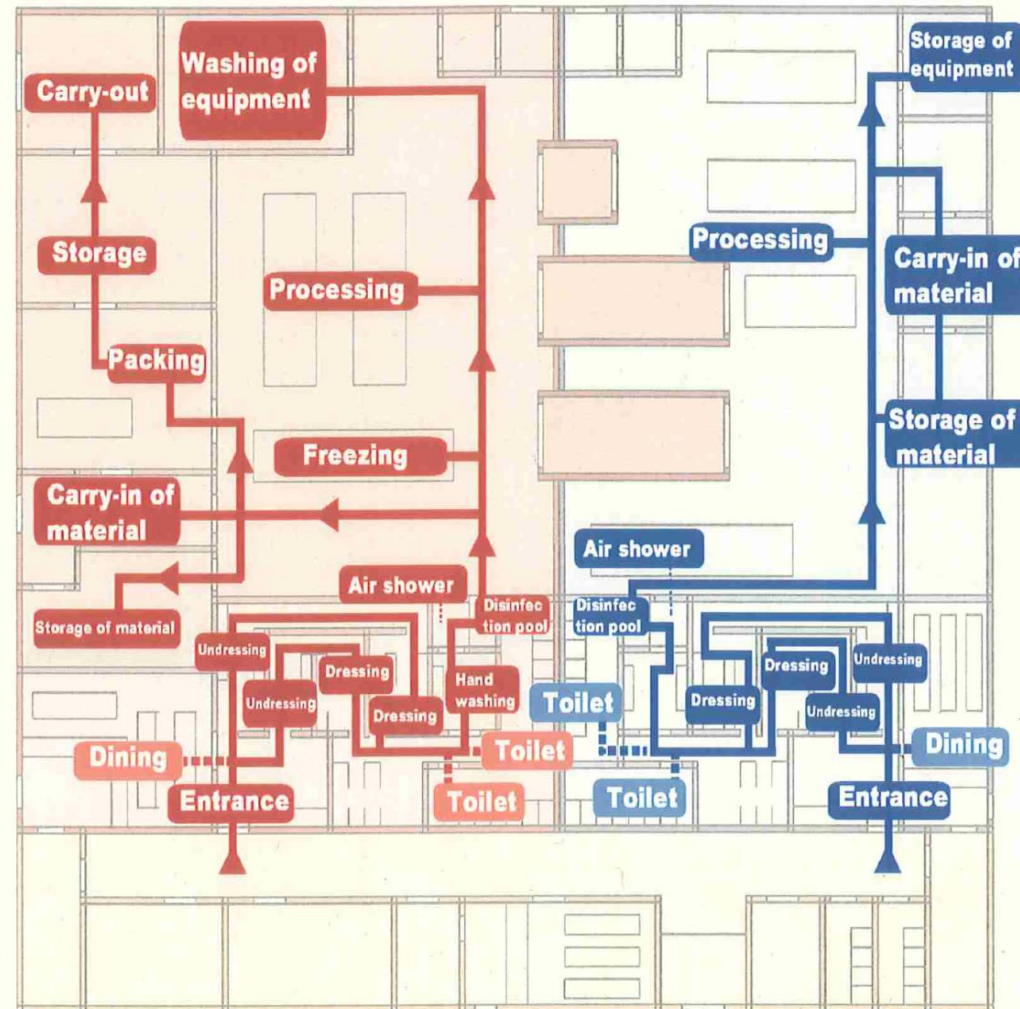

Traffic line of raw material, products and packaging material

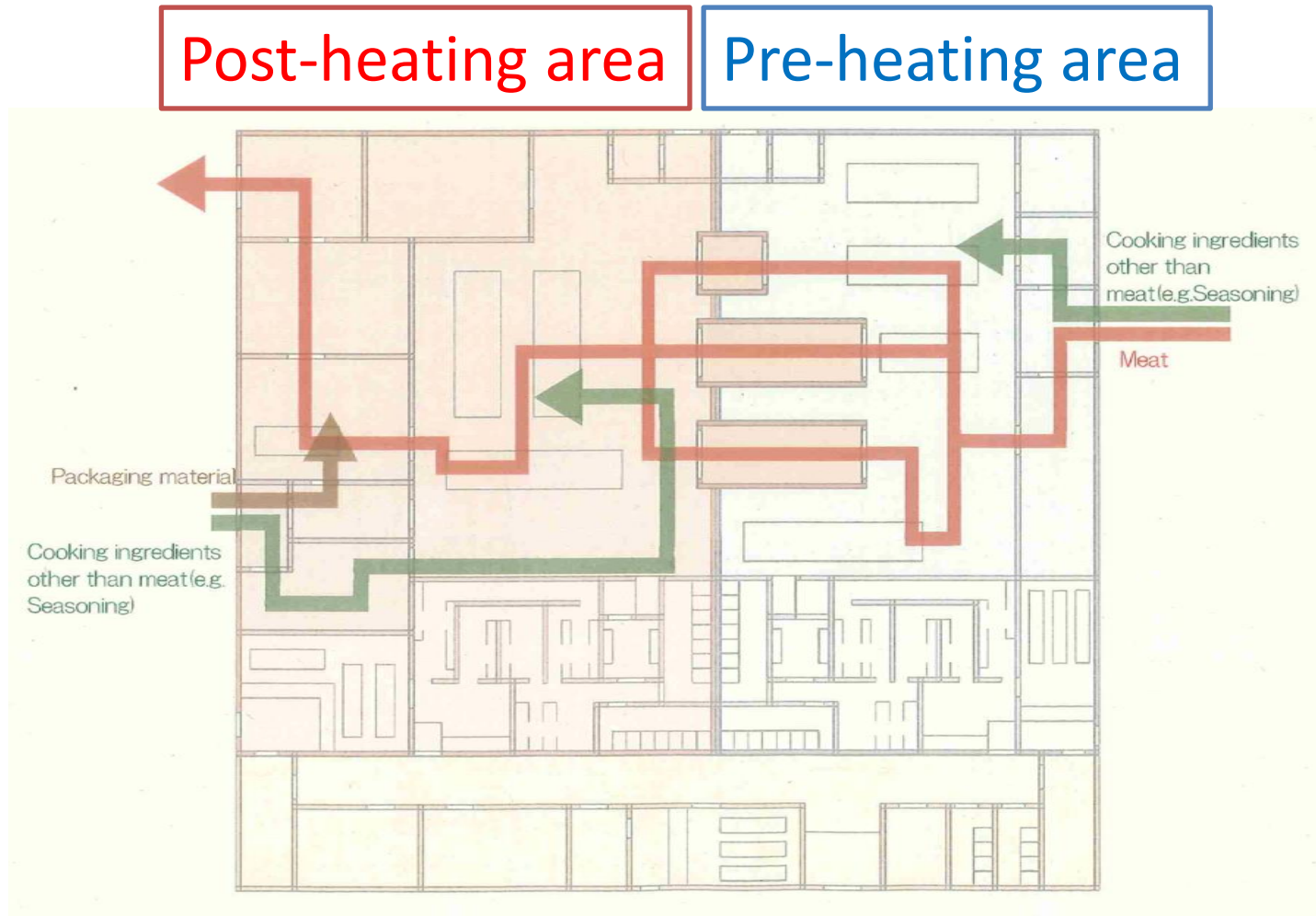

Traffic line of waste

Post-heating area

Pre-heating area

